



PLANK & PENCIL PROFILE (Standard)



PLANK PROFILE



STRIATED PROFILE



MINOR RIBS PROFILE



FLAT PROFILE

Low Profile - Product Data

APPLICATIONS

Symmetrical roof/wall panel used on slopes down to 1:12.
Continuous length up to 80'.
Convex curving only - 10ft minimum radius.

SUBSTRATES

Plywood, Metal Deck

MATERIAL

Standard - 24 GA. ASTM A792 (50 ksi)
Optional - 22 GA. ASTM A792 (50 ksi)

MANUFACTURING

Roll formed in factory or at jobsite.

FINISHES

Acrylic Coated Galvalume
Fluoropolymer (Kynar 500 PVDF resin-based)

PAN CONDITIONS

Plank & Pencil Rib, Plank, Striated, Minor Ribs and Flat
(Oil canning is inherent in all metal panels and is not cause for panel rejection. A signed oil canning acknowledgement will be required for all orders prior to production.)

TESTING*

Uplift: UL 580, UL 1897, ASTM E1592
Air & Water Infiltration: ASTM E1680, ASTM E1646
Florida Product Approval: FL 22330 (Shingle Recover System)
Impact Resistance: UL Class 4, FM Class 1-SH
Texas Department of Insurance# RC-664 (for 16" Panel in 0.040" Aluminum only)
Testing and Approvals are product specific. Inquire for details.

NOTE: All data represented on this sheet may not be applicable to all widths and gauges. Contact ExSteel for more information.

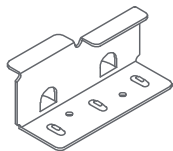

STANDARD CLIP

16 GA. Galvanized G90 - ASTM A635 (50 ksi)
16 GA. Stainless 304SS - ASTM A240 (50 ksi)

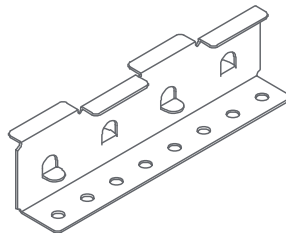

8" SHINGLE RECOVER CLIP

16 GA. Galvanized G90 - ASTM A635 (50 ksi)
16 GA. Stainless 304SS - ASTM A240 (50 ksi)

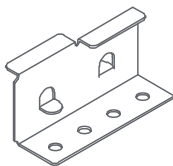

4" ASV CLIP

16 GA. Galvanized G90 - ASTM A635 (50 ksi)
16 GA. Stainless 304SS - ASTM A240 (50 ksi)

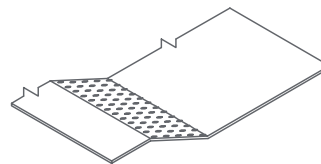

VENTED EAVE/RIDGE TRIM

0.063 Aluminum - ASTM B209 3003

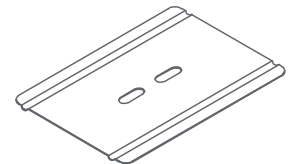

BEARING PLATE

24 GA. - ASTM A792 (50 ksi)

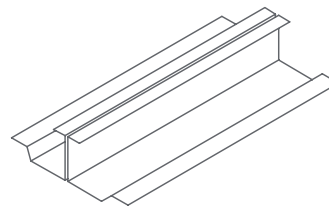

MULTI-SPAN CLIP 2-Piece

Standard: 24 GA. - ASTM A792 (50 ksi)
Optional: 22 GA. - ASTM A792 (50 ksi)
Typically sold in 10' lengths

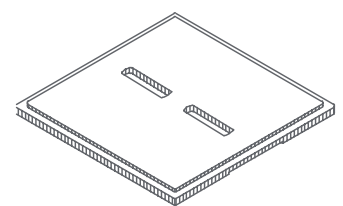

STACKABLE LEVELING SHIM

6" x 6" x 1/4" Thick

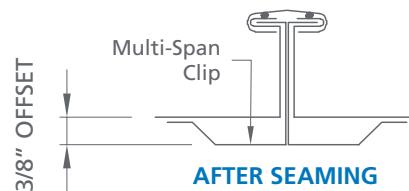
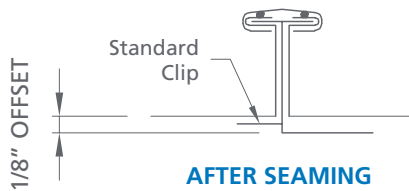
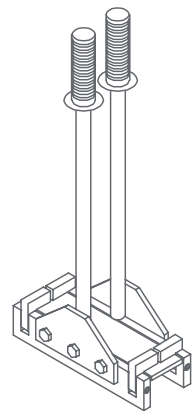
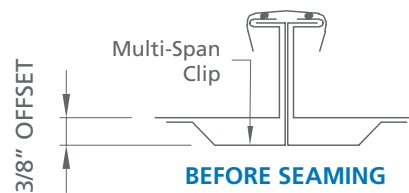
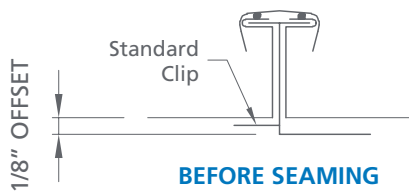
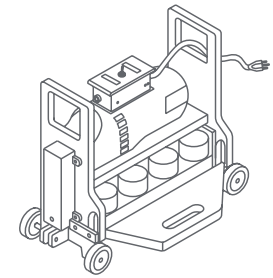
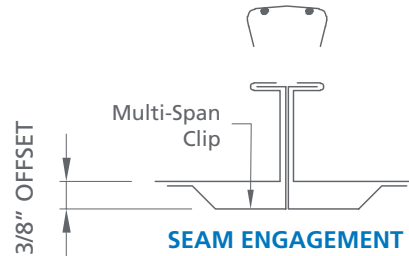
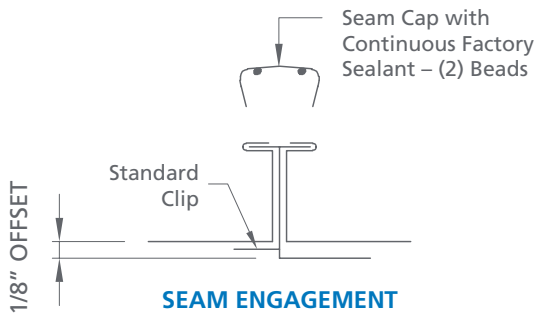

NOTE: All data represented on this sheet may not be applicable to all widths and gauges. Contact ExSteel for more information.

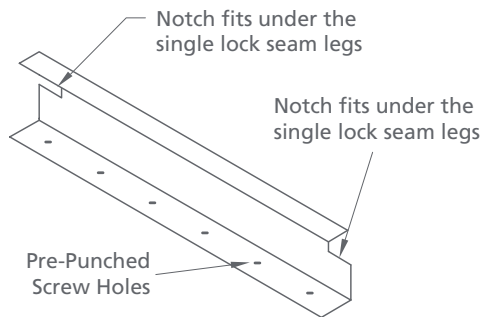

CLOSURE
Optimum Widths 16"
Additional lengths for hips available.
24 GA. - ASTM A792 (50 ksi)

